

RECOMMENDING APPROVAL AS TO:

HEAD ARCHITECTURAL SECT.

APPROVED:

BUILDING OFFICIAL

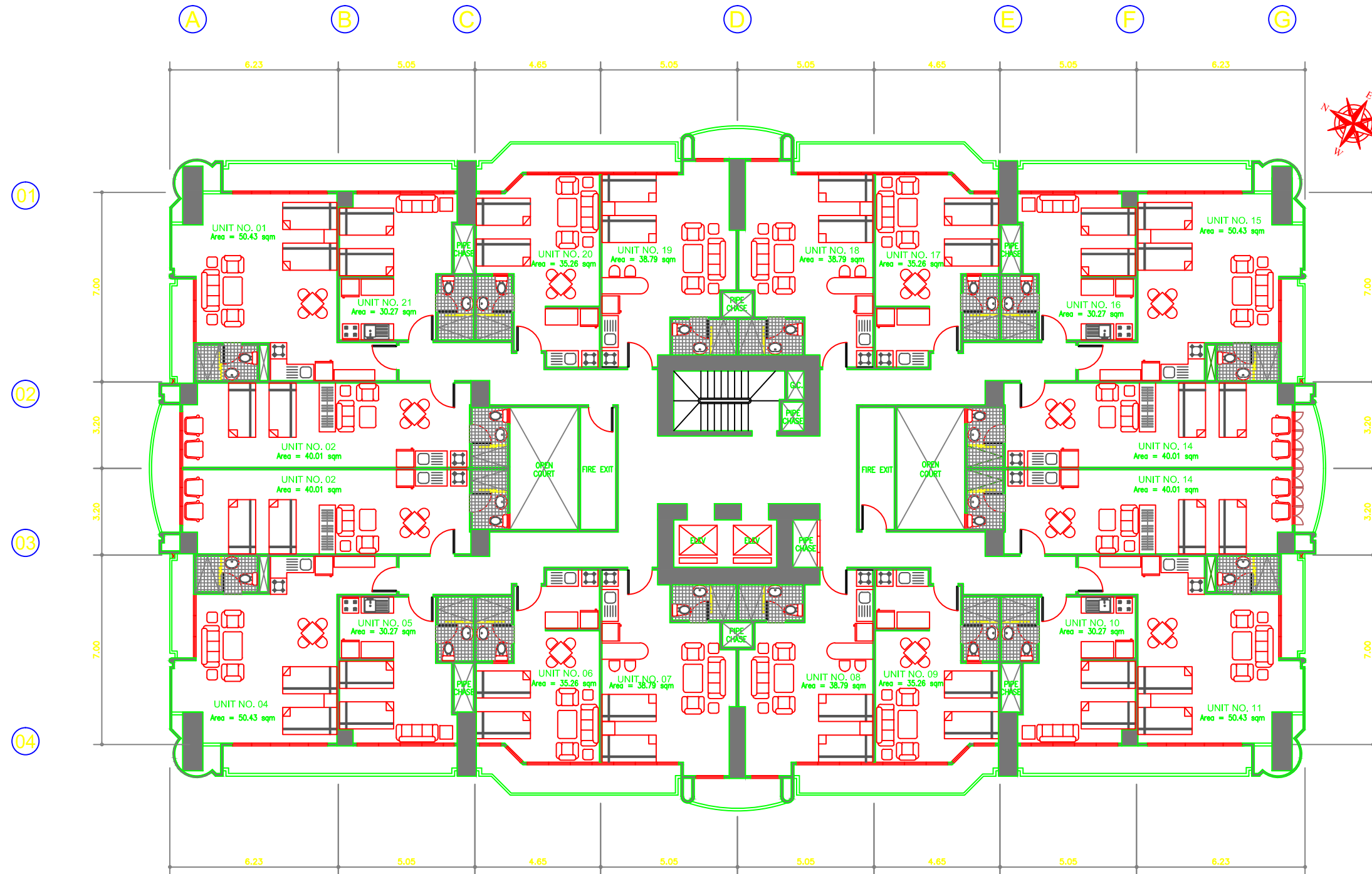

5th - 25 TH FLOOR PLAN
SCALE: 1:100 MTS.

<p>NELSON G.YU ARCHITECT</p> <p>REG. NO. 8192 DATE: 9-23-85 PTR. NO. 121-8627 DATE: 07-11-12 TIN: 100-166-184</p>	<p>PROJECT : WINLAND TOWER CONDOMINIUM</p>	<p>REVISIONS :</p> <p>NOTE: THIS DRAWING AS AN INSTRUMENT OF SERVICE IS A PROPERTY OF NELSON G. YU AND ASSOCIATES AND AS SUCH MUST NOT BE REPRODUCED OR COPIED IN PART OR IN WHOLE WITHOUT PERMISSION. ALL DRAWINGS ARE TO BE RETURNED WHEN NO LONGER IN USE. REPUBLIC ACT 845</p>	<p>SHEET CONTENTS :</p> <p style="text-align: center;">GROUND FLOOR PLAN</p>				<p>PROJECT NO.</p>
	<p>OWNER : CEBU WINLAND DEVELOPMENT CORP.</p> <p>LOCATION : JUANA OSMENA ST., CEBU CITY</p>		<p>DESIGNED BY :</p>	<p>CADD BY : REVIVED</p>	<p>CHECKED BY :</p>	<p>DATE :</p>	<p>SHEET NO. :</p>